

PowerStar™ *i* Series

Simulated Sinewave UPS

600VA-2000VA

» Intelligent » Reliable » Plug & Play



BPC have a range of intelligent Line Interactive UPS products, designed to offer total power protection to a broad range of applications.

The PowerStar *i* Series range will provide clean and reliable backup power to ensure continued data integrity and optimum performance under a wide range of mains power conditions to offer total power protection to a broad range of modest applications.

This high level of power protection can be incorporated with our advanced power management and diagnostics software package that will allow your IT Manager or Systems Integrator to remotely monitor and manage both the UPS and IT application.

- » Fully intelligent line interactive
- » Microprocessor based design
- » LCD touch screen user interface
- » Boost and buck AVR for voltage stabilisation
- » Cold start function
- » Built in USB communication port
- » Overload protection
- » Intelligent power management
- » Compact size

PowerStar™ i Series

Technical Specification



MODEL	PSTARi600	PSTARi800	PSTARi1000	PSTARi1500	PSTARi2000
Power Rating VA / Watts	600 / 360	800 / 480	1000 / 600	1500 / 900	2000 / 1200
INPUT					
Nominal Voltage	220 Vac / 230 Vac / 240 Vac				
Voltage Range	162 - 290 Vac				
Frequency	50 or 60 Hz (auto-sensing)				
OUTPUT					
Nominal Voltage	220 Vac / 230 Vac / 240 Vac				
Frequency	±1 Hz				
Transfer Time	Typical 2-6ms				
Overload Capacity (Online)	110% ±10% (Fault alarm after 5 minutes), 120% ±10% (shutdown immediately)				
BATTERY					
Battery Type	VRLA AGM Sealed Lead Acid Maintenance Free Batteries				
Charging Current (max.)	Approximately 1A				
Charging Voltage	13.7 ±0.5V (normal mode)				
GENERAL					
Temperature/Humidity	0 - 40°C / 0 - 90% (non-condensing)				
Acoustic Noise level	Less than 40dB				
Management Software	Included				
Dimensions (mm) WxDxH	101 x 300 x 142			130 x 300 x 182	
Net Weight (kgs)	4.4	5	8.2	10.4	11

- 1 AC Input
- 2 USB Communication
- 3 Output Battery Backup Connection
- 4 RJ-45 Connection
- 5 Output Surge Only Connection

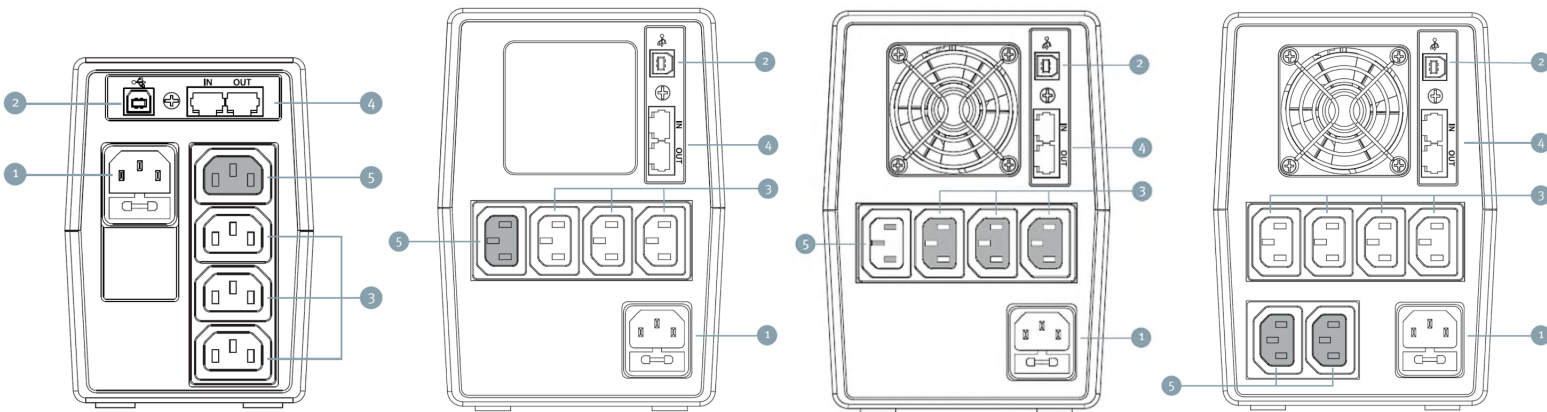

600VA - 800VA Models

1000VA Models

1500VA Models

2000VA Models